

# solo per teste TM-TRM for TM-TRM heads only

## su staffa - *on arm*

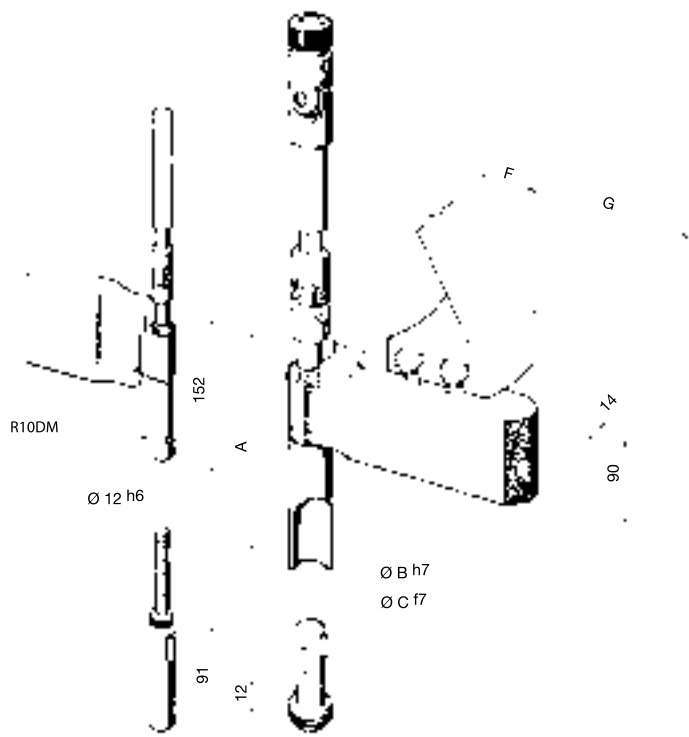

Tipi mandrini <i>spindles type</i>	10DM	15DM	22DM
Codice <i>code</i>	R10DM-S5 R10DM-S6	R15DM-S5 R15DM-S6	R22DM-S5 R22DM-S6
Capacità maschiatura <i>tapping</i>	M6	M12	M16
Corsa maschiatura <i>Tapping stroke</i>	40	40	40
A	152	208	217
ØB h7	12	20	28
ØC f7	20	32	40
F	59	55	55
G	200 270	200 270	200 270
Interasse minimo <i>center distance</i>	23	32,5	40,5
Peso <i>weight</i>	kg 4,0 4,5	5,2 5,7	6,6 7,4

## su astuccio per flangia fissa - *fixed plate spindle*

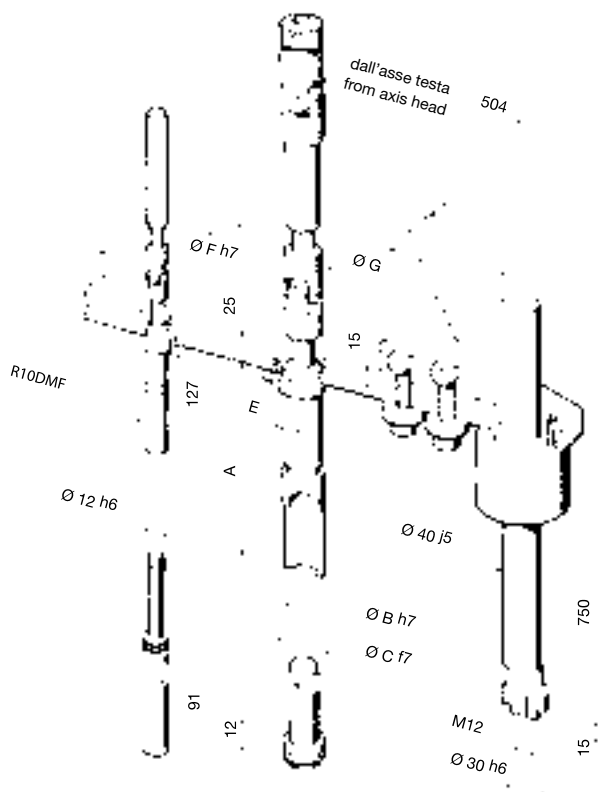

Tipi mandrini <i>spindles type</i>	10DM	15DM	22DM
Codice <i>code</i>	R10DMF	R15DMF	R22DMF
Capacità maschiatura <i>tapping</i>	M6	M12	M16
Corsa maschiatura <i>Tapping stroke</i>	40	40	40
A	127	183	192
ØB h7	12	20	28
ØC f7	20	32	40
E Interasse vite M6 <i>distance crew M6</i>	18,5	25	29
ØF f7	23	31	39
ØG	27	36	44
Interasse minimo <i>center distance</i>	23,5	32,5	40,5
Peso <i>weight</i>	kg 2,0	2,6	3,8

FH

BAH

TA.CP

TA

MO

HT

VH

TSI/TSX

T

MT-TC-TC3

Accessori  
Accessories

Appendice tecnica  
Technical supplement