



testa ad angolo - angle head

# TAL26

caratteristiche/features



  
 ø 26    M20    3020 N  

  
 1-1            2500

peso/weight

  
 20 kg

rotazione/rotation

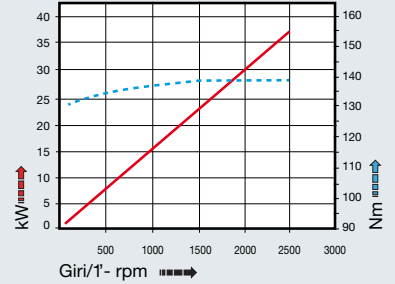

  
 input                      output

prestazioni/performance

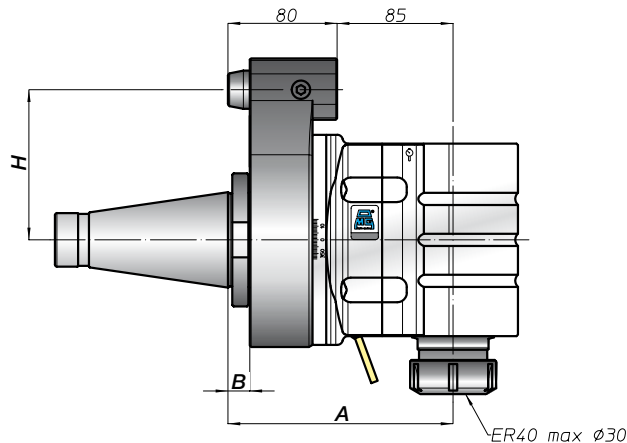
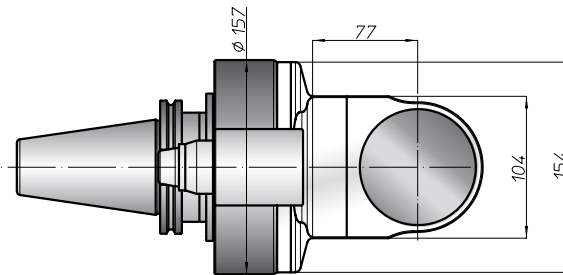
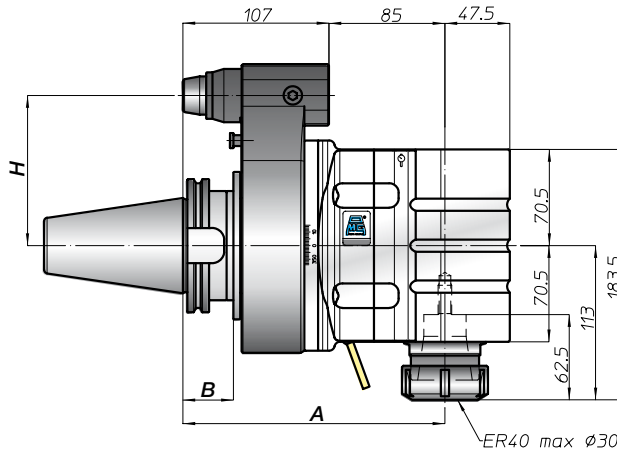
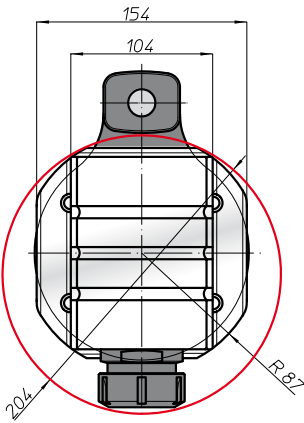

tipi mandrino disponibili / available spindle types

- 2** Albero portafresa  
Milling shaft  
Ø16-Ø27-Ø32
- 3** Weldon  
Whistle-Notch  
Ø32
- 4** DIN69893-HSK  
HSK63
- 5** COROMANT  
CAPTO®  
C4
- 6** ABS  
Licenza KOMET®  
ABS50



CONO SHANK	size	H			
		A	B	standard	optional
DIN69871 *	-	-	-	-	-
	45	-	-	110	-
	50	192	35	110	-
ANSIB5.50 *	-	-	-	-	-
	50	-	-	110	-
BT *	-	-	-	-	-
	50	200	45	110	-
HSK	-	-	-	-	-
DIN69893	80	201	46	110	-
	100	-	-	-	-
CAPTO	-	-	-	-	-
ISO26623	-	196	-	110	-
	C8	-	-	-	-
KM	-	-	-	-	-
	-	192	-	110	-
	100	-	-	-	-
DIN2080	-	-	-	-	-
	-	165	16	110	-
	50	-	-	-	-
NMTB	-	-	-	-	-
ANSIB5.18	50	165	16	110	-

\* Option: Dual Contact

